

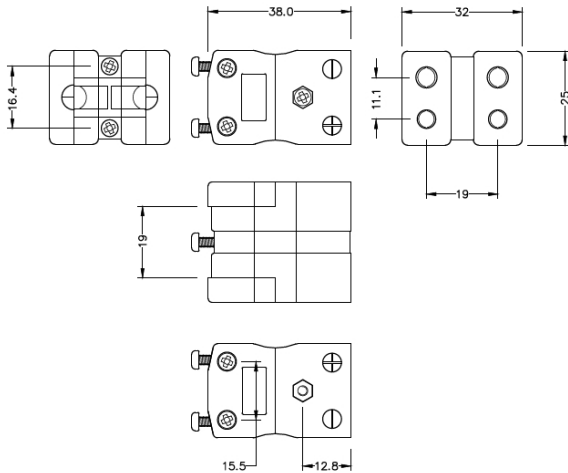

LABFACILITY

TEMPERATURE & PROCESS TECHNOLOGY

Standard Thermocouple Connecteur Duplex Socket AS-R/S-FD Type R/S ANSI



Standard Duplex in-line Socket
(dimensions in mm)



Labfacility are the UK's leading manufacturer of Temperature Sensors, Thermocouple Connectors and associated Temperature Instrumentation and stockings of Thermocouple Cables. The Company has been trading since 1971 and is ISO9001 accredited.

Standard Thermocouple Connecteur Duplex Socket AS-R/S-FD Type R/S ANSI

Corps en polyester remplis de verre accidenté. Les contacts sont polarisés pour éviter une connexion incorrecte

Spécifications
Specifications

Product Code	XE-1627-001
General Description	<p><p>Standard Thermocouple Connector Duplex Socket AS-R/S-FD Type R/S ANSI</p></p> <p><p>Rugged glass filled polyester bodies. Contacts are polarised to prevent incorrect connection</p></p> <p><p style="text-align: center;">*** See specifications tab for full details ***</p></p> <p><p><iframe src="https://www.youtube-nocookie.com/embed/RNP6kn3ZP0M?rel=0&amp;controls=0&amp;showinfo=0" height="258" width="500"></iframe></p></p>
Thermocouple Type	R/S ANSI
Connector Type	Duplex Socket
Connector Size	Standard
Colour	Green
Dimensions	See Schematic Drawing (Product Literature Tab)
Max. Temperature	220°C
+Positive Contact	Copper



LABFACILITY

TEMPERATURE & PROCESS TECHNOLOGY

-Negative Contact	Copper Alloy
Standards Met	BS EN 50212:1997. RoHS